



RPL105

RPL106 / 118



### BINDINO, intelligent bilge switch, flood prevention sensor

Intelligent electronic switches for bilge pumps and flood water pumps. They monitor the presence of water and activate the suction pump. They automatically adjust their operating parameters based on the type of liquid present, ensuring operation with any water mixture. Can be powered with any voltage between 10 and 30 Vdc. A status Led shows the working conditions.

#### Technical specifications

- Microprocessor technology
- Power consumption: min 0,4 W (relay at rest), 0,9 W (relay activated)
- Adapts to any water mixture
- No moving parts subject to mechanical blocks
- Avoids false pumping
- Protection class: IP68
- Power supply: 10...30 Vdc
- Max. relay load RPL105 and RPL106: 16 A (N.A. type SPST)
- Max. relay load RPL118: 1 A
- Activation delay: approx. 10 sec.
- Disconnection delay: approx. 30 sec.
- Operating temperature: 0...60°C
- Dimensions RPL105: 82 (A) x 73 (B) x 36mm (C)
- Dimensions RPL106 and 118: 91 (A) x 72 (B) x 36mm (C)
- Weight: ~ 250 g (with 1 m cable)

#### Applications

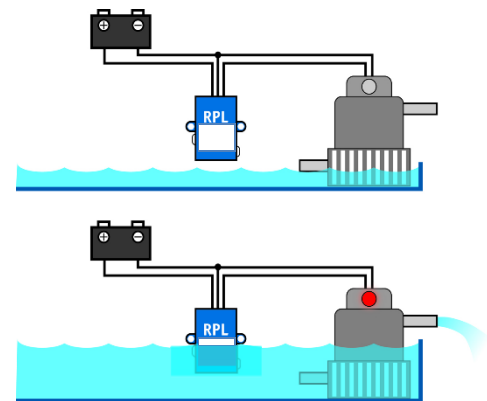

Code	Description
RPL105	Intelligent bilge pump switch, 16A relay
RPL106	Intelligent bilge pump switch with contact plates, 16A relay
RPL118	Flood prevention sensor with contact plates, 1A relay

RPL105

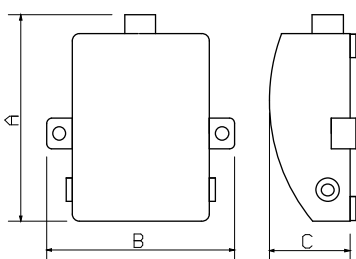

RPL106 and RPL118

